

What is a **STORMWATER PLANTER**?

- structures with open bottom to allow stormwater to slowly infiltrate into the ground
- contains a layer of gravel, soil, and vegetation
- runoff temporarily pools on top of soil, slowly infiltrates through planter into the ground
- ideal for space-limited sites with good drainage

BENEFITS

- reduces stormwater runoff, flow rate, volume, temperature, and pollutants
- recharges groundwater

VEGETATION

- shrubs, small trees, and other plants that tolerate seasonally moist and dry soil conditions

MAINTENANCE

- Inspect plants and structural components periodically
- Remove sediment and clear debris from curb cuts to maintain proper drainage.



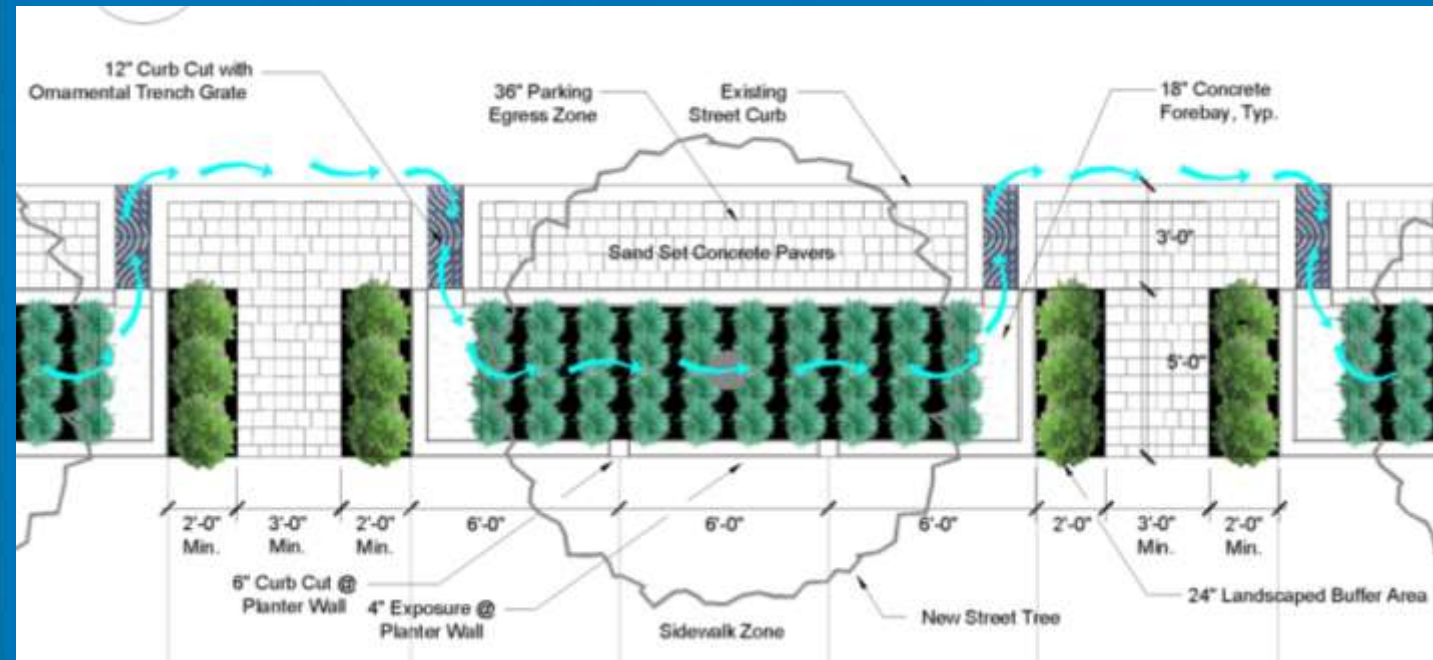

CASE STUDY: PORTLAND, OREGON GREEN STREETS

Source:
 City of Portland
 Bureau of
 Environmental
 Services

Stormwater Planters

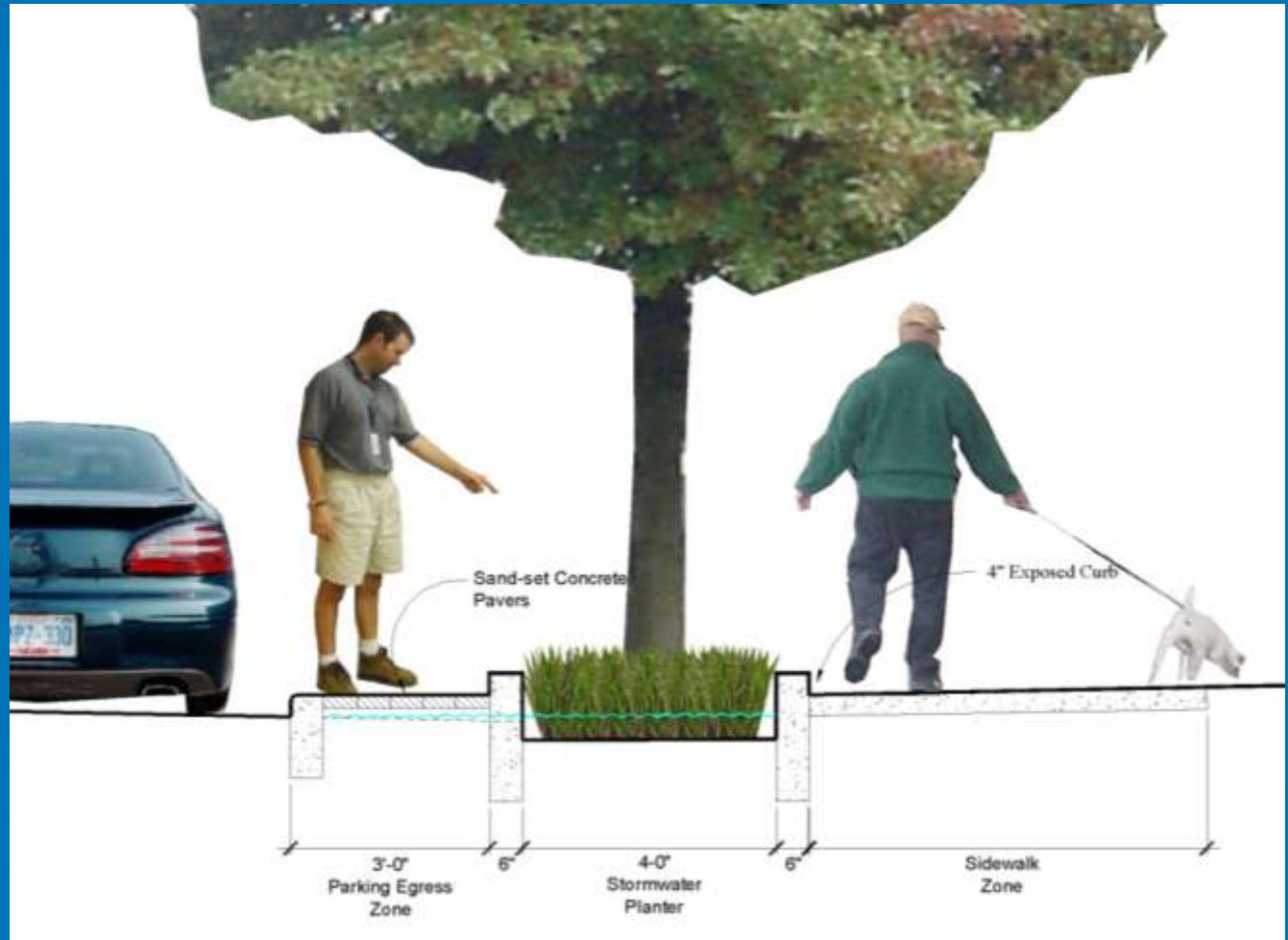

Source:
*City of Portland
Bureau of
Environmental
Services*

PORTLAND, OREGON GREEN STREETS

Stormwater Planters



Source:
*City of Portland
Bureau of
Environmental
Services*

PORTLAND, OREGON GREEN STREETS

Stormwater Planters



Source:
*City of Portland
Bureau of
Environmental
Services*

PORTLAND, OREGON GREEN STREETS

Stormwater Planters



PORTLAND, OREGON GREEN STREETS

Source:
*City of Portland
Bureau of
Environmental
Services*

Stormwater Planters



Source:
*City of Portland
Bureau of
Environmental
Services*

PORTLAND, OREGON GREEN STREETS

Stormwater Planters on Alabama Street :

- depth from varies from 12” to 18”
- min. 6” depth from street to finish grade inside planter
- stormdrain overflow above 6” storage
- width varies from 4’-0” to 9’-6”
- 2” mulch over 12” of sandy topsoil
- drip irrigation
- sedge meadow plantings tolerate dry, wet, salty cond’s

Safety Features:

- 4” high curb edge protection along trail edge
- 18” offset from edge of trail
- at-grade plantings keeps users away from ends
- plantings extend above top, visible from street/trail

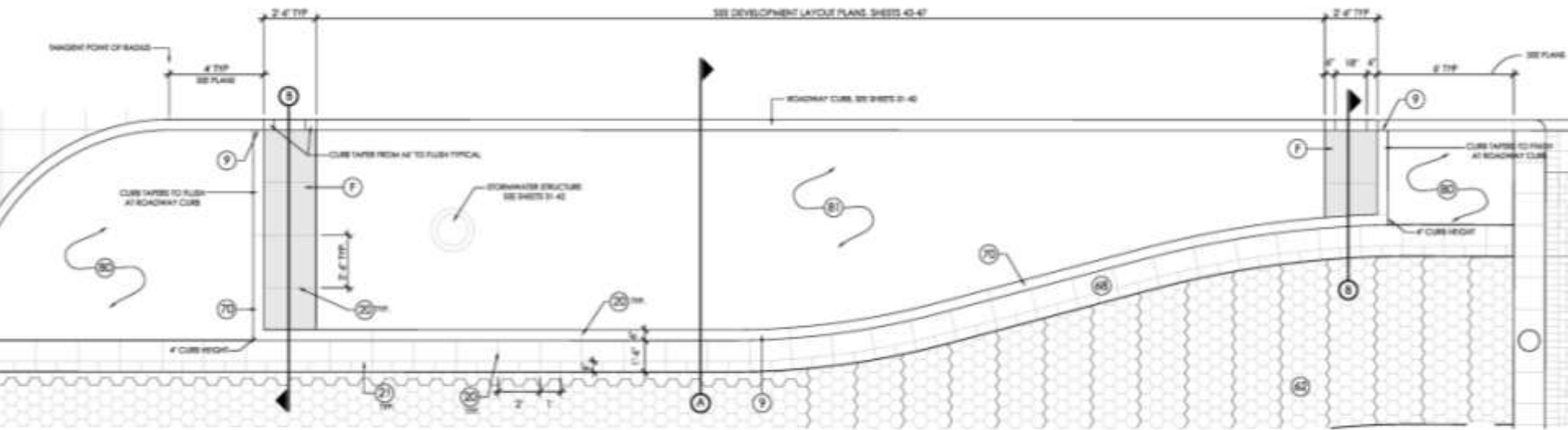

EXAMPLE PLAN
SCALE 1/8" = 1'-0"

- NOTES:**
1. DOWNSLOPE PLANTER FABRY IN CONFIGURATION. THIS EXAMPLE PLAN IS SHOWN TO ILLUSTRATE THE TYPICAL COMPONENTS & REFERENCE THE TYPICAL SECTIONS.
 2. SIDEWALKS TO EXISTING DRIVE WIDTH OF PLANTER BED.
 3. ALL EXPOSED FACES OF PLANTER CURB ARE TO BE FINISHED.
 4. PLANTER CURB SHALL HAVE CONTROL JOINTS AT 12' O.C. MAX. AND DOWNDRY JOINTS AT 20' O.C. AND ALL RETURN JOINTS MUST ALIGN WITH PCCP & T&E JOINTS.
 5. SEE SHEETS 81-82 FOR PLANTING PLAN.
 6. SEE SHEETS 83-87 FOR REGULATION PLANS.

SECTION 1
SIDEWALK, C&G
SHEET 27
SECTION 2
SIDEWALK, C&G
SHEET 27

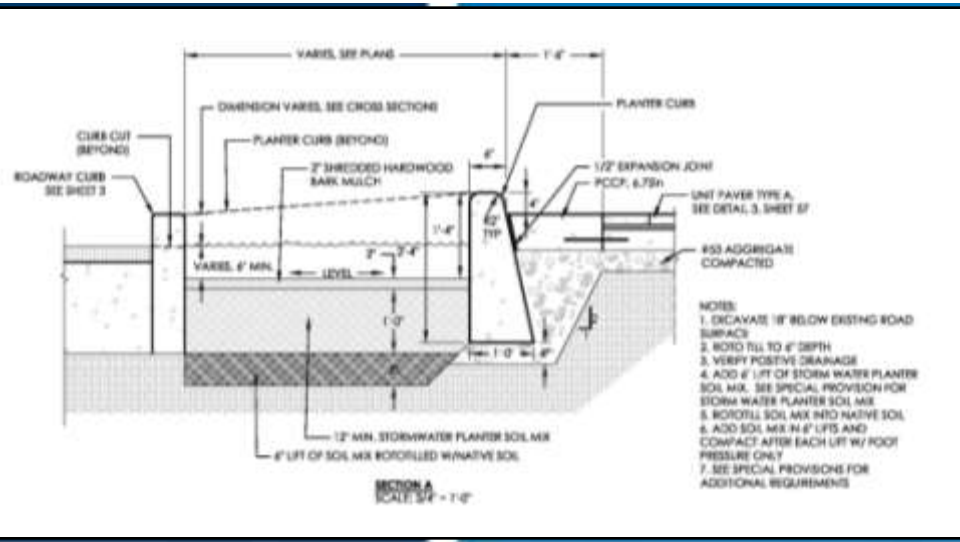

- NOTES:**
1. EXCAVATE 18\"/>

SECTION A
SCALE 3/4" = 1'-0"

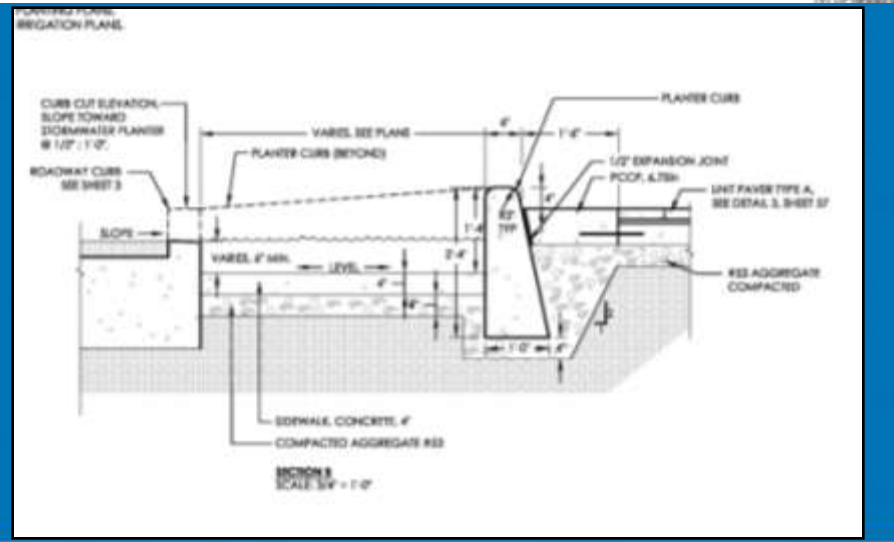

SECTION B
SCALE 3/4" = 1'-0"

Stormwater Planters

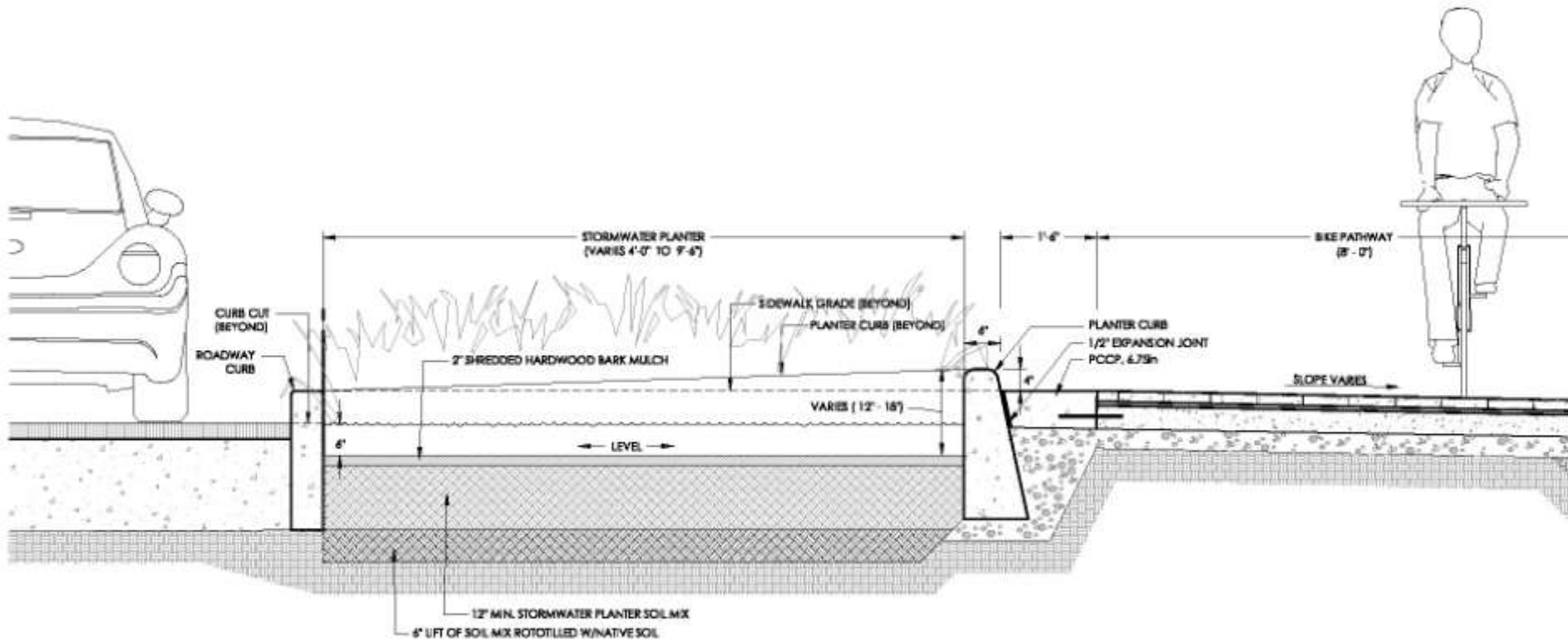

Stormwater Planters

Botanical Name: *Juncus torreyi*
 Common Name: **Torrey's Rush**
 Species Category: **Wetland Rush**



One of the most distinctive rushes, with dense bunches of round "seedballs" borne at the tips of erect stems, this plant performs best in damp soils and adds structure and interest in hard-to-landscape situations. Blooming from June-July, this greenish-brown plant grows 1'-3' tall.



Botanical Name: *Carex frankii*
 Common Name: **Bristly Cattail Sedge**
 Species Category: **Wetland Sedge**



This small, box-shaped, light green flowerheads on stout stems has attractive grass-like foliage and prefers moist to wet soil. It grows to heights of 2'-3' tall, prefers full sun conditions and is ideal for attracting songbirds.



Botanical Name: *Iris virginica*
 Common Name: **Blue Flag Iris**
 Species Category: **Wetland Forb**



An outstanding wetland wildflower with showy, 2"-4" blue to violet blooms, this species grows in areas with damp soils and in water up to 12" deep. Blooming from late spring to mid summer, this 2'-3' tall plant, with its wide, silver-green leaves, is a perfect choice for water gardens. It grows slowly and may take up to five years to produce its first blooms.



PROPOSED PLANTINGS



Stormwater Planters



Stormwater Planters



Stormwater Planters



Stormwater Planters



Stormwater Planters



Stormwater Planters